

**NE PORTION OF
T11N, R18W**
of
Fruitland Township
Muskegon County, Michigan

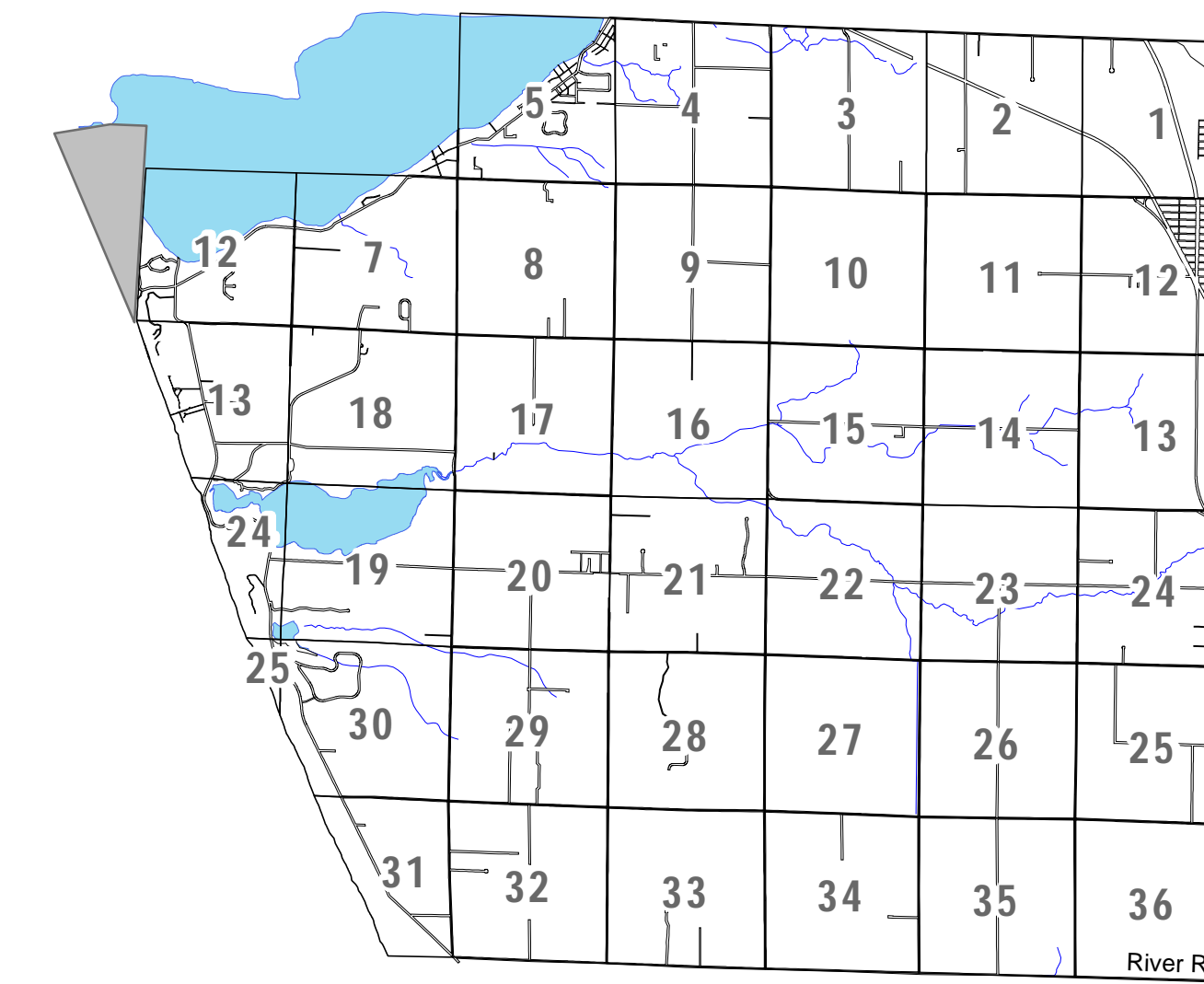

Location Map
Scale: 1"=6000'

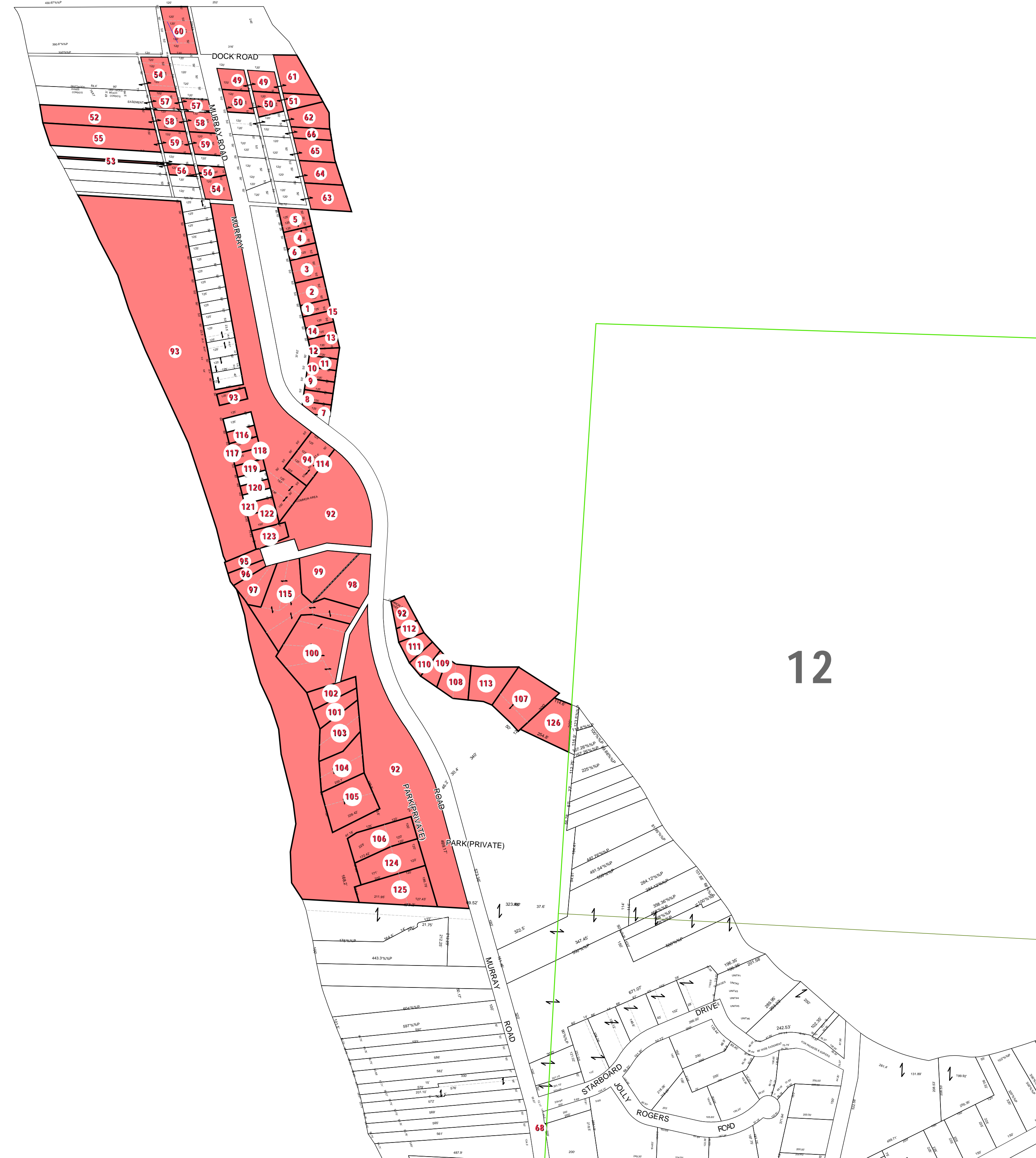

- Legend**
- Section Lines
 - Streams & Rivers
 - Parcels
 - Polygons without Database Information

ID Number	Parcel Number
1	06-002-004-0001-59
2	06-002-004-0001-60
3	06-002-004-0001-61
4	06-002-004-0001-62
5	06-002-004-0001-63
6	06-002-004-0001-67
7	06-011-004-0001-50
8	06-011-004-0001-51
9	06-011-004-0001-52
10	06-011-004-0001-53
11	06-011-004-0001-54
12	06-011-004-0001-55
13	06-011-004-0001-56
14	06-011-004-0001-57
15	06-011-004-0001-58
25	06-106-400-0016-00
48	06-154-000-0000-00
49	06-230-003-0002-00
50	06-240-003-001-0002-00
51	06-240-004-001-0002-00
52	06-245-0010003-00
53	06-245-001-0010-00
54	06-245-002-0001-00
55	06-245-0020004-00
56	06-245-002-0006-00
57	06-245-002-001-0002-00
58	06-245-002-001-0003-00
59	06-245-002-002-0008-00
60	06-245-0020027-00
61	06-245-004-0002-00
62	06-245-004-0003-00
63	06-245-004-0013-00
64	06-245-004-0015-00
65	06-245-004-0017-00
66	06-245-004-0019-00
68	06-385-000-0008-00
92	06-578-000-0000-00
93	06-578-000-0001-00
94	06-578-000-0001-25
95	06-578-000-0001-29
96	06-578-000-0001-30
97	06-578-000-0001-31
98	06-578-000-0001-32
99	06-578-000-0001-33
100	06-578-000-0001-34
101	06-578-000-0001-35
102	06-578-000-0001-36
103	06-578-000-0001-37
104	06-578-000-0001-38
105	06-578-000-0001-39
106	06-578-000-0001-40
107	06-578-000-0001-43
108	06-578-000-0001-45
109	06-578-000-0001-46
110	06-578-000-0001-47
111	06-578-000-0001-48
112	06-578-000-0001-49
113	06-578-000-0001-64
114	06-578-000-0001-65
115	06-578-000-0001-66
116	06-578-003-0001-20
117	06-578-003-0001-21
118	06-578-003-0001-22
119	06-578-003-0001-23
120	06-578-003-0001-24
121	06-578-003-0001-26
122	06-578-003-0001-27
123	06-578-003-0001-28
124	06-579-000-0001-41
125	06-579-000-0001-42
126	06-579-000-0001-44

Source Data
 Hydrography - Michigan Geographic Framework
 Roadways - Muskegon County Equalization
 Sectional Information - Muskegon County Equalization
 Parcels - Muskegon County Equalization

